



**[12 LESSONS FROM CREATING
EMERGING SCIENCE CENTERS]**

WAYNE LABAR

wlabar@alchmeystudio.com



ALCHEMY *studio*



COMMUNITY



SCIENCE AND
EDUCATION



INTERACTION
AND
ENGAGEMENT



IMMERSION



TRANSFORMATION

EXPERIENCE



BUILDING/FACILITY

OPERATIONS

PROCESS

CONTENT/EXPERIENCE



BUILDING/FACILITY



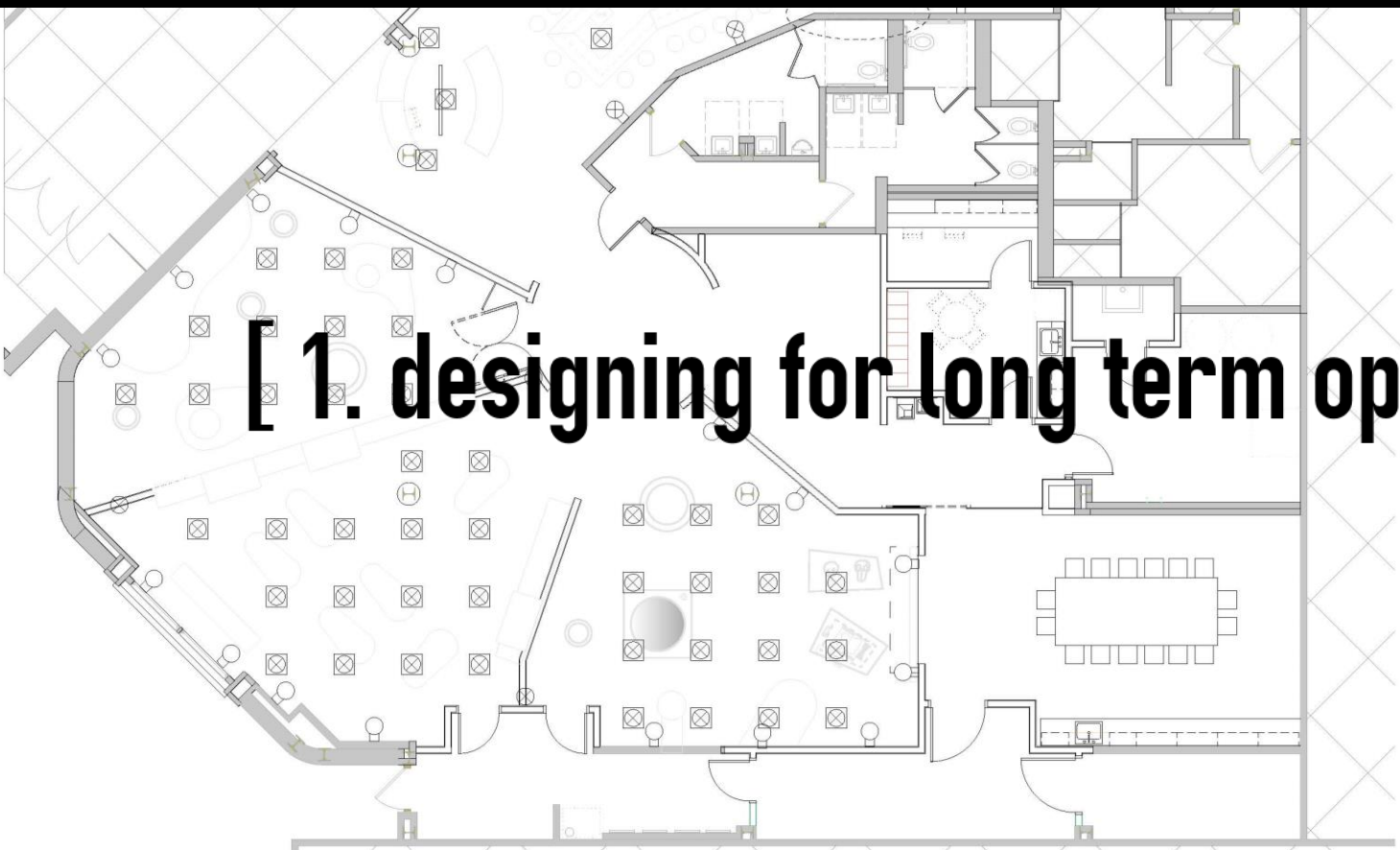

- Electrical Legend
- ⊗ Power/data needed at base building wall for outlets in fabricated exhibit walls
 - ⊙ 110 V wall duplex with data
 - ⊠ 110 V wall duplex at 96" with data
 - ⊞ Ceiling power/data for drop to below

Scale: 1/8" = 1'0"

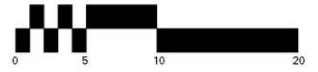



[2. the building can get in the way of the exhibits]

[3. it's not just any building]





ALCHEMY
studio

OPERATIONS





[4. understand the audience model]

[5. bottom up development from the

community]



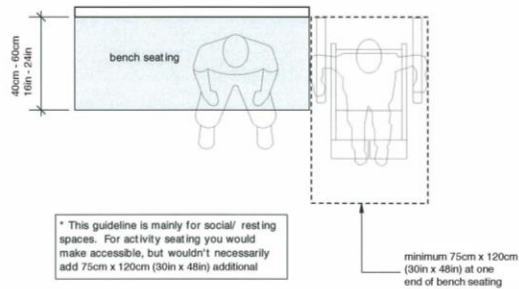

Accessible spaces adjacent to fixed seating allow a person in a wheelchair to sit with persons with whom they may be traveling.

Seating

Ref: (Smithsonian:48)

[6. model of safety and accessibility]

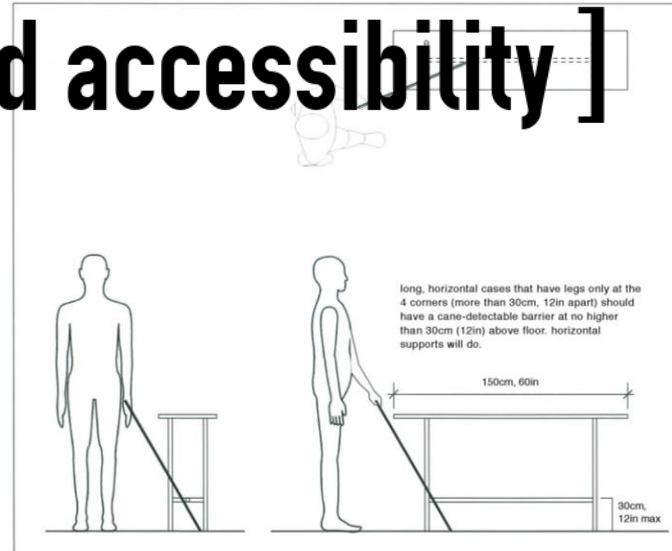
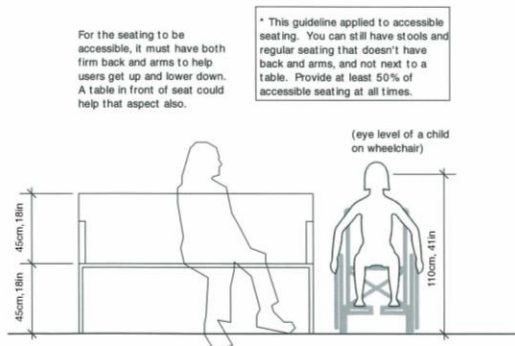



ALCHEMY
studio

PROCESS

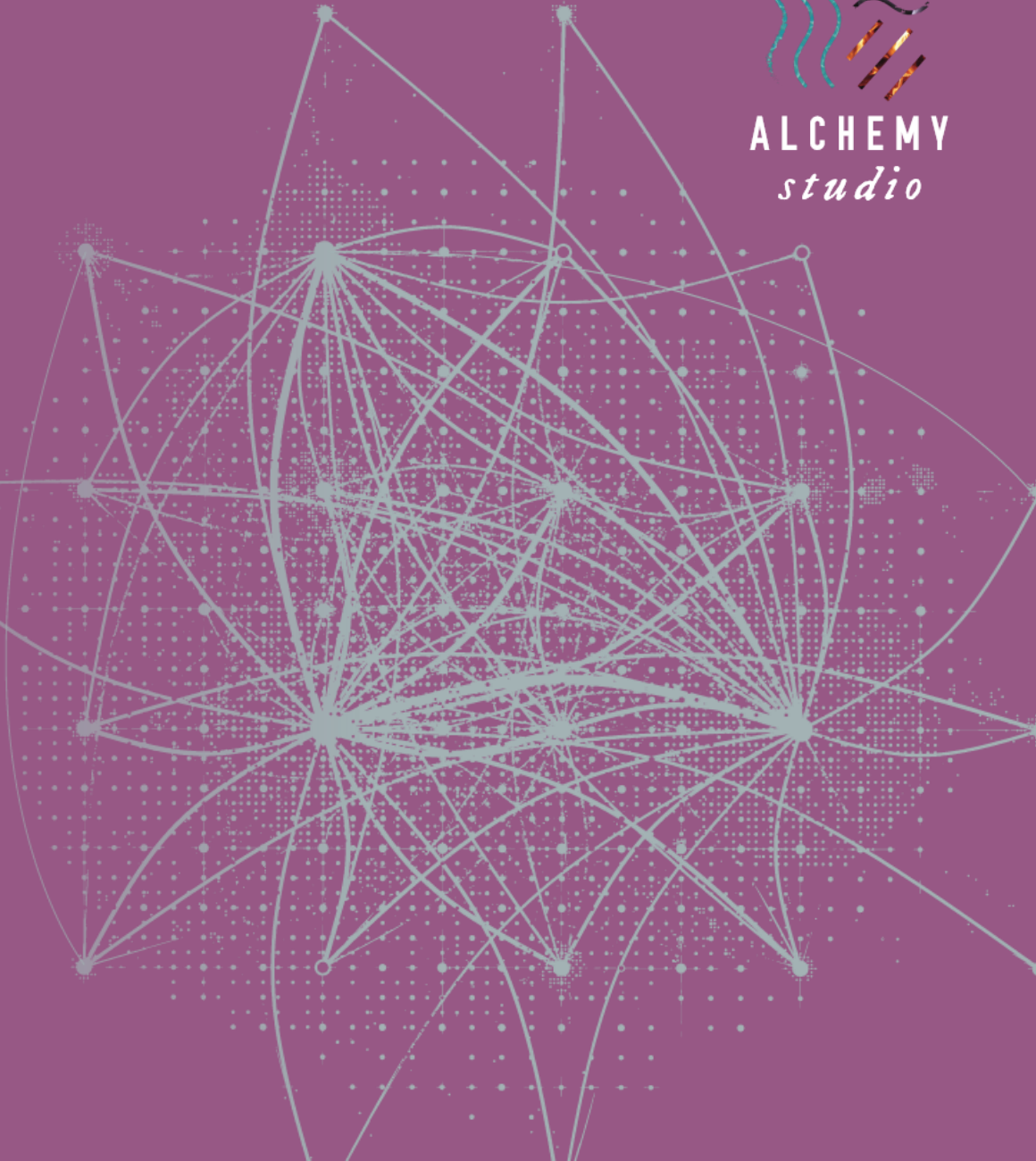

[7. be prepared for phasing the work]

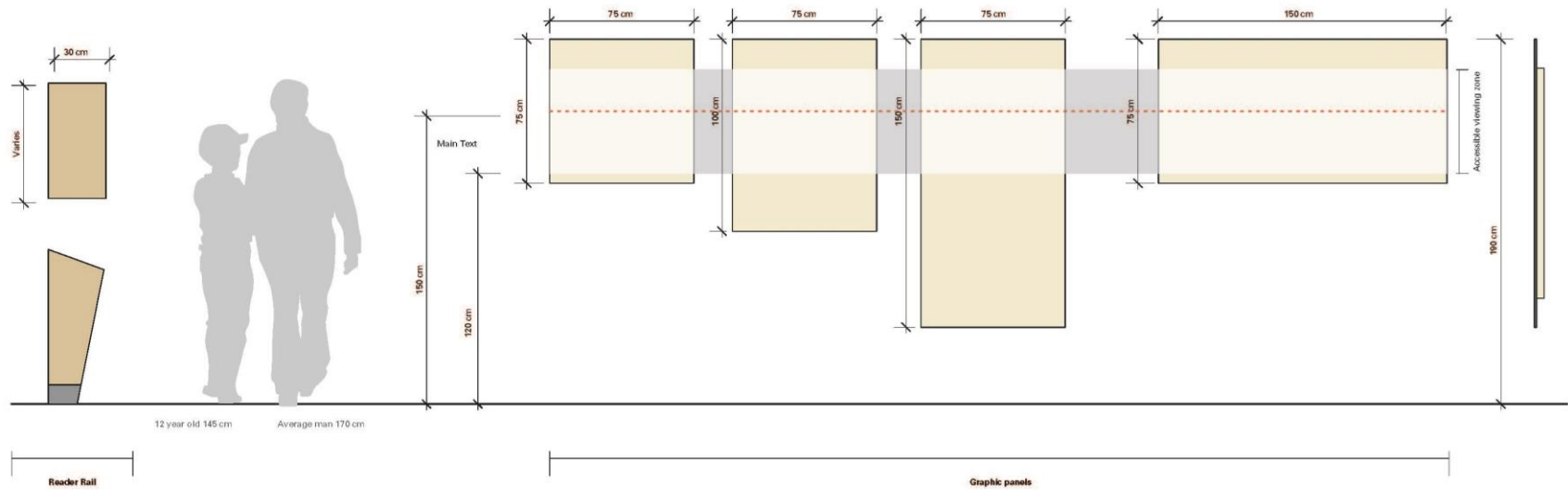

[9. don't spend everything]





CONTENT / EXPERIENCE

A close-up photograph of a traditional tulip-shaped glass filled with amber-colored tea, topped with a layer of white foam. The glass sits on a matching saucer. Wisps of steam rise from the tea, suggesting it is hot. The background is dark and out of focus.

[10. being aware of cultural norms]

[11. make it relevant]



[12. ask for more]





ALCHEMY
studio

[www.alchemystudio.com]
[wlabar@alchemystudio.com]